

## Forged Steel Piston Check Valve Class 800 Conventional Port (Socket Weld)

**Figure Number: B3674XUW**

### Piston Check valve, Conventional Port, Bolted Bonnet, Socket Weld Ends

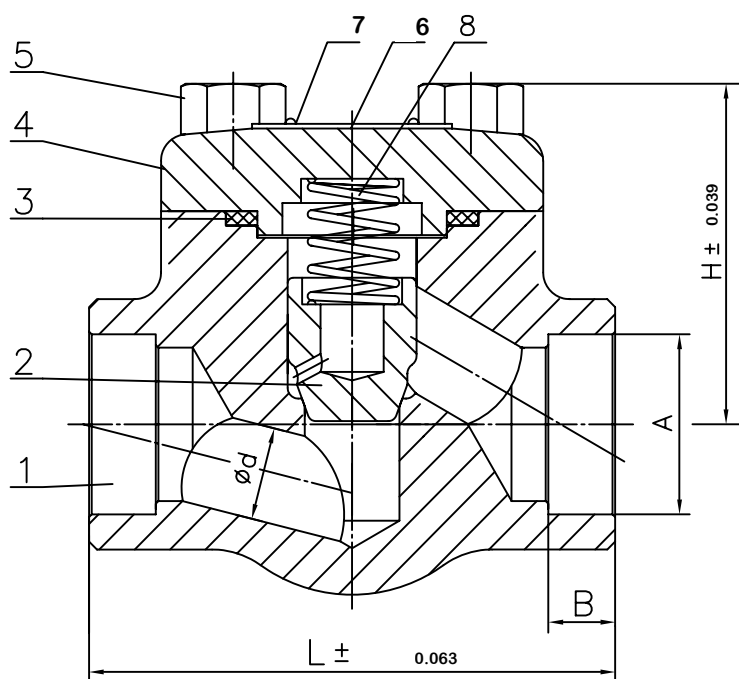

2	6.30	2.41	0.63	4.02	1.42				
11/2	5.71	1.92	0.50	3.35	1.14				
11/4	4.49	1.68	0.50	3.15	0.89				
1	3.94	1.33	0.50	2.56	0.69				
3/4	3.15	1.07	0.50	2.20	0.47				
1/2	2.87	0.86	0.38	2.09	0.35				
3/8	2.87	0.69	0.38	2.09	0.35				
1/4	2.87	0.56	0.38	2.09	0.28				
inch	L	A	B	H	d				
NPS									
5	Bolt		ASTM A193 B7						
4	Bonnet		ASTM A105N						
3	Gasket		304+Graphite		8	Spring	SS304		
2	Disc		ASTM A276 420		7	Rivet	H62		
1	Body		ASTM A105N+STL		6	Nameplate	304		
No.	Name		Material		No.	Name		Material	

## Technical Requirements

1. Design & manufacture conform to API 602
2. Test & inspect conform to API 598
3. Face to Face dimension conform to manufacturer's standard
4. SW ends coform to ASME B16.11

# Forged Steel Swing Check Valve Class 800 Conventional Port (Socket Weld)

**Figure Number: B3675XUW**

Swing Check valve, Conventional Port,  
Bolted Bonnet, Socket Weld Ends

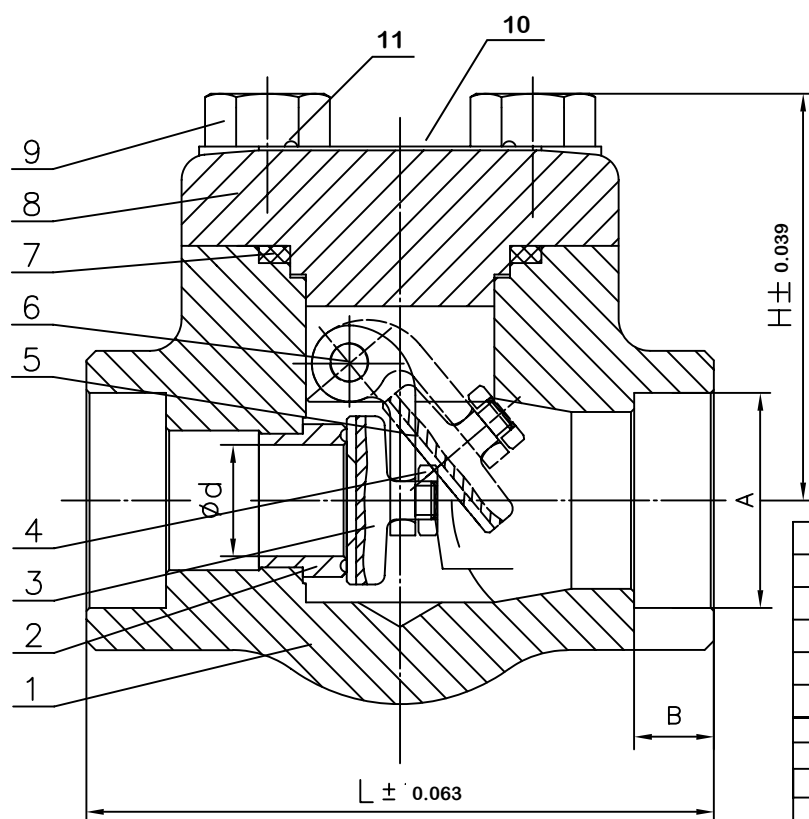

2	5.12	2.41	0.63	4.09	1.44			
11/2	4.72	1.92	0.50	3.54	1.14			
11/4	4.49	1.68	0.50	3.15	0.94			
1	3.94	1.33	0.50	2.56	0.69			
3/4	3.15	1.07	0.50	2.20	0.51			
1/2	2.87	0.86	0.38	2.09	0.37			
inch	L	A	B	H	d			
5	Arm	ASTM A351 CF8	10	Nameplate	11	Rivet		
4	Nut	ASTM A94 8	9	Bolt		ASTM A193 B7		
3	Disc	ASTM A276 420	8	Bonnet		ASTM A105N		
2	Seat	ASTM A276 410+STL	7	Gasket		304+Graphite		
1	Body	ASTM A105N	6	Pin		ASTM A276 304		
No.	Name	Material	No.	Name		Material		

## Technical Requirements

1. Design & manufacture conform to API 602
2. Test & inspect conform to API 598
3. Face to Face dimension conform to manufacturer's standard
4. SW ends coform to ASME B16.11

# Forged Steel Ball Check Valve Class 800 Conventional Port (Socket Weld)

**Figure Number: B3673XUW**

Ball Check valve, Conventional Port,  
Bolted Bonnet, Socket Weld Ends

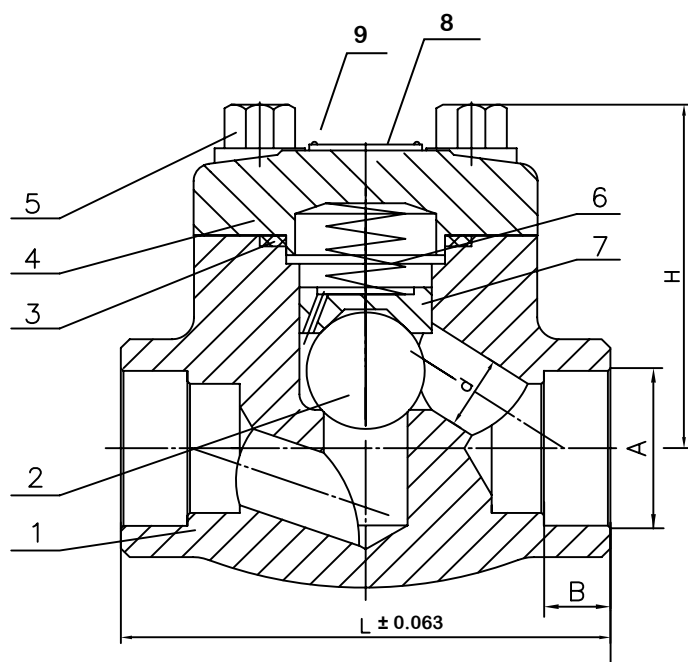

2	6.30	2.41	0.63	4.02	1.42			
1 1/2	5.71	1.92	0.50	3.35	1.14			
1 1/4	4.49	1.68	0.50	3.15	0.89			
1	3.94	1.33	0.50	2.56	0.69			
3/4	3.15	1.07	0.50	2.20	0.47			
1/2	2.87	0.86	0.38	2.09	0.35			
3/8	2.87	0.69	0.38	2.09	0.35			
1/4	2.87	0.56	0.38	2.09	0.28			
inch NPS	L	A	B	H	d			
5	Bolt		ASTM A193 B7					
4	Bonnet		ASTM A105N		9	Rivet		
3	Gasket		304+Graphite		8	Nameplate		
2	Ball		ASTM A276 420		7	Ball seat	ASTM A276 410	
1	Body		ASTM A105N+STL		6	Spring	SS304	
No.	Name		Material		No.	Name		Material

## Technical Requirements

1. Design & manufacture conform to API 602
2. Test & inspect conform to API 598
3. Face to Face dimension conform to manufacturer's standard
4. SW ends coform to ASME B16.11